

Franklyn James



Escapade Place, Blackwall, London, E14 0WH Asking Price £617,500

A Property That Feels Like a House, Just Minutes from Canary Wharf.

Just a short stroll from Blackwall DLR, this welcoming split-level property by Beech Grove Homes offers a rare sense of space and independence in the heart of London's Docklands. With its own private entrance, the home is arranged over two floors, combining the feel of a house with the convenience of modern apartment living. On the ground floor, you will find two generously sized double bedrooms, offering flexible options for guests, working from home, or creating your own quiet retreat.

Upstairs, the property opens into a bright and airy open-plan kitchen, dining and living area, providing the perfect setting for everything from quiet mornings to entertaining friends. A separate winter garden sits just off the lounge, adding an extra layer of versatility to the space, whether you are after a reading corner, a plant-filled haven, or simply somewhere to relax.

A modern shower room and a dedicated utility area complete the upper floor, bringing useful functionality to the home without compromising on design.

Finished with a sleek, contemporary aesthetic, the interior features integrated Zanussi appliances, Silestone worktops and stylish flooring throughout. Every detail has been carefully considered to create a comfortable and high-quality living environment.

All of this within easy reach of Canary Wharf's restaurants, shops and excellent transport links. With the Elizabeth line nearby, central London is more accessible than ever.

- Split-level maisonette with private entrance
- Two generous double bedrooms on ground floor
- Expansive open-plan living/kitchen on upper floor
- Spacious winter garden
- Utility room and stylish shower room
- High-spec interior with integrated appliances
- Short walk to Blackwall DLR
- Moments from Canary Wharf's shopping, dining, and transport links

Viewing

Please contact our Limehouse Sales Office on 02077911777 if you wish to arrange a viewing appointment for this property or require further information.



Floor Plan

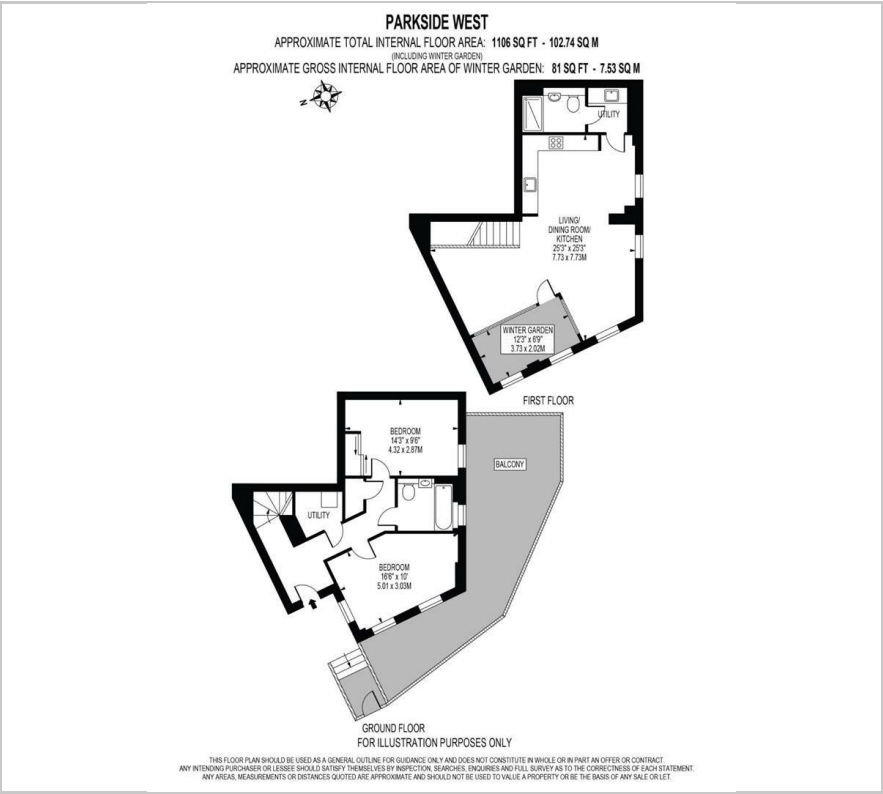

Area Map

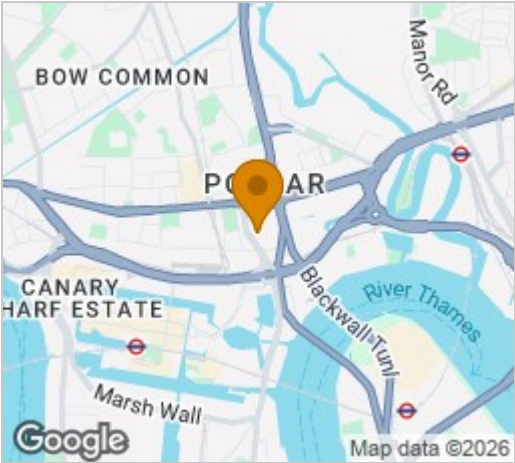

Energy Efficiency Graph

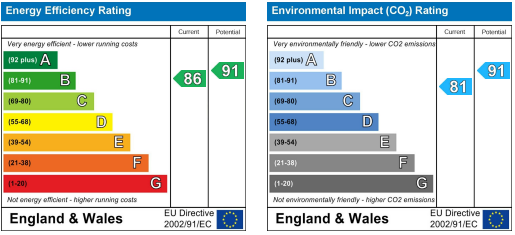

These particulars, whilst believed to be accurate are set out as a general outline only for guidance and do not constitute any part of an offer or contract. Intending purchasers should not rely on them as statements of representation of fact, but must satisfy themselves by inspection or otherwise as to their accuracy. No person in this firms employment has the authority to make or give any representation or warranty in respect of the property.